

PELI™ 1700 CASE GENERATION 2

TECH BULLETIN | 18/04/23

DESIGNED IN

U S A

SINCE 1976



1700 GEN 2

1700 GEN 1

MATERIAL NUMBERS

017000-0000-XXE (with Foam)
017000-0010-XXE (with No Foam)

1700-000-XXE (with Foam)
1700-001-XXE (with No Foam)

DIMENSIONS (L X W X H)

Ext: 97.7 x 41.7 x 15.6 cm
Int: 90.8 x 34.9 x 13.6 cm

Ext: 96.8 x 40.6 x 15.5 cm
Int: 90.8 x 34.3 x 13.3 cm

BOSSES ADDED INSIDE THE LID

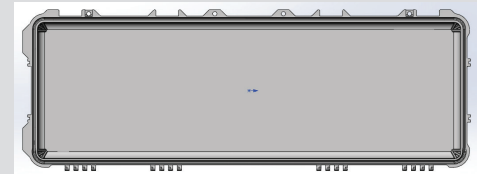
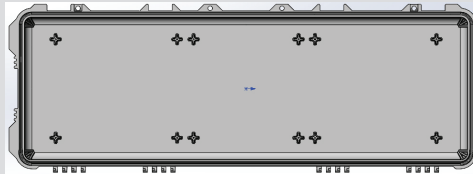

NEW FOLDING OVERMOLDED HANDLE

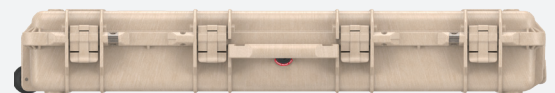

WIDER WHEEL PLACEMENT AND NEW END HANDLE



RIBS MODIFIED ON THE BACK



CONVOLUTED LID FOAM

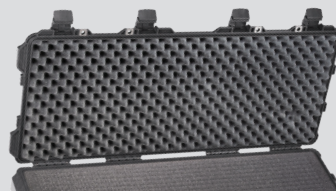

Peli Products, S.L.U.

C/Provenza, 388 Planta 7 • 08025 • Barcelona, Spain

Tel +34 93 467 4999

PELI.COM

All trademarks are registered and/or unregistered trademarks of Pelican Products, Inc., its subsidiaries and/or affiliates.

©2023 Peli Products, S.L.U.

GUARANTEED FOR LIFE*
SEE [PELI.COM/GUARANTEED FOR FULL DETAILS](https://www.peli.com/guarantee)

*Where Applicable by Law